

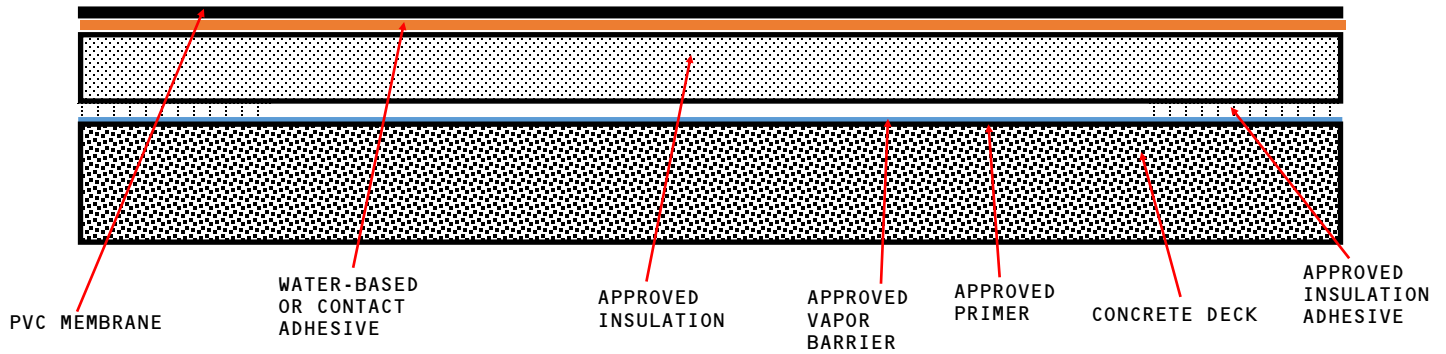

PHOENIX
PRODUCTS™

GD-IN(RB)-VB-C
Quick Spec

GLUE DOWN MEMBRANE - INSULATION (RB) - VAPOR BARRIER - CONCRETE DECK (NEW OR TEAR OFF)



APPROVED INSULATION: UL CLASSIFIED POLYISOCYANURATE INSULATION.

NOTES:

1. Attach Insulation with Approved Insulation Adhesive. Refer to Detail Drawings "Ribbon Insulation Adhesive pattern GD-17 and GD-18".