

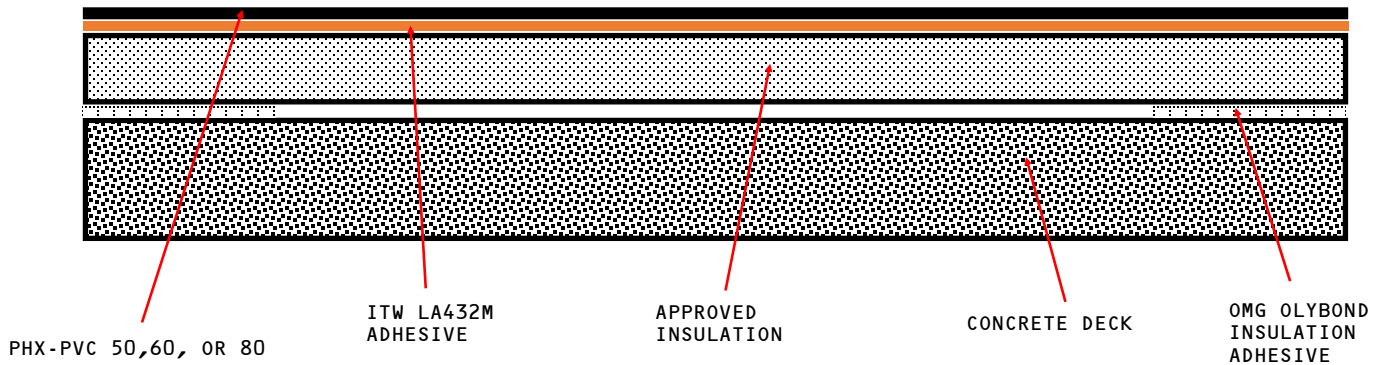

PHOENIX
PRODUCTS™

GD-IN(RB)-C RoofNav Assembly

GLUE DOWN MEMBRANE - INSULATION (RB) - CONCRETE DECK (NEW OR TEAR OFF)



APPROVED INSULATION: HUNTER PANELS, RMAX OR ATLAS UL CLASSIFIED INSULATION.

RoofNav Assembly Properties:

Assembly #: 210465-0-0	Slope: 1.0000
Roof System: Single-Ply System	Wind Uplift*: 270
Application: New Roof	Internal Fire: NC
Cover Securement: Adhered	Exterior Fire: A
Deck Type: Structural Concrete	Hail: SH
Assembly limited to use with noncombustible walls only:	No

NOTES:

1. Attach Insulation with Approved Insulation Adhesive. Refer to Detail Drawings "Ribbon Insulation Adhesive pattern GD-17 and GD-18".