

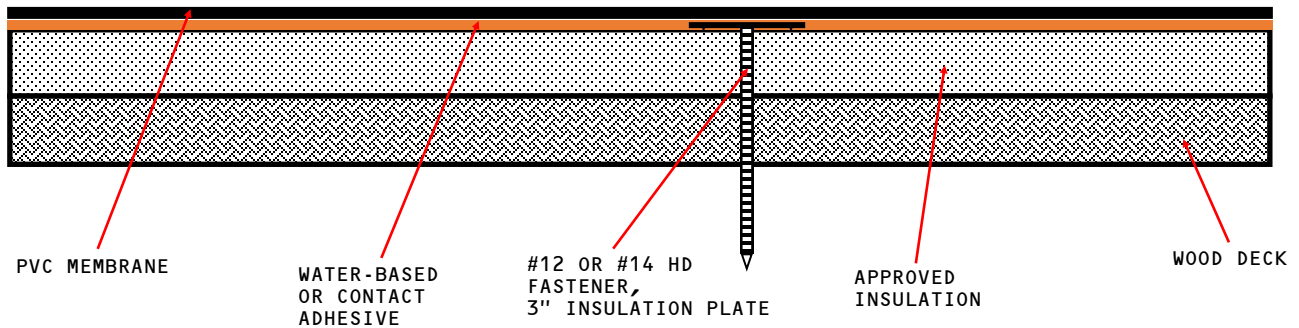

**PHOENIX**  
PRODUCTS™

**GD-IN(MF)-W**  
**Quick Spec**

GLUE DOWN MEMBRANE - INSULATION (MF) - WOOD DECK (NEW OR TEAR OFF)



**APPROVED INSULATION:** UL CLASSIFIED POLYISOCYANURATE INSULATION.

**NOTES:**

1. Attach Insulation with #12 or #14 HD Fasteners and 3" Steel Insulation Plate. Refer to Detail Drawings "Fastening Pattern Insulation/Coverboard GD-2 through GD-11".