

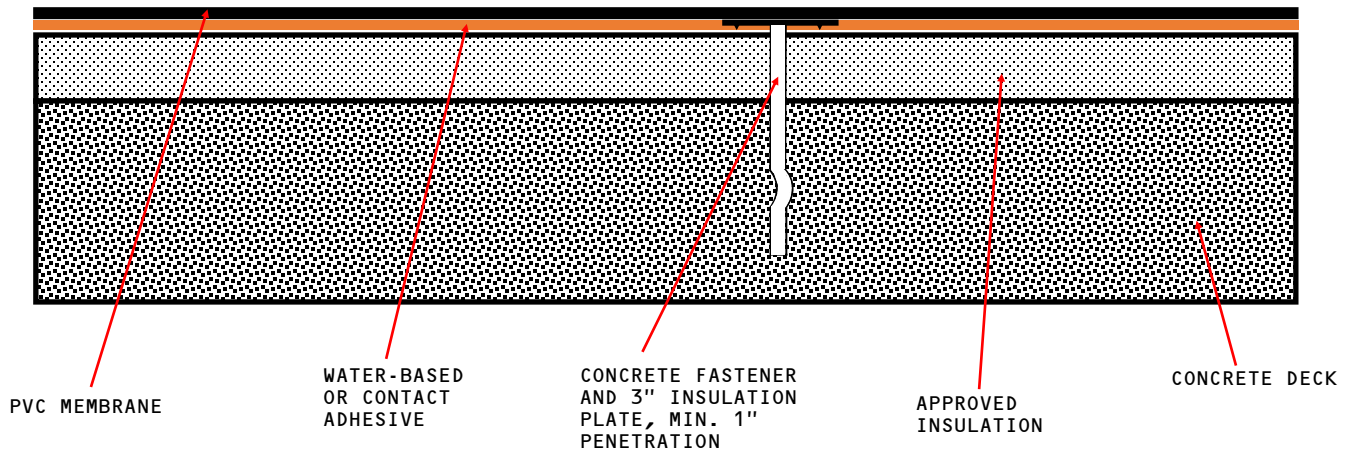

PHOENIX
PRODUCTS™

GD-IN(MF)-C
Quick Spec

GLUE DOWN MEMBRANE-INSULATION (MF) - CONCRETE DECK (NEW OR TEAR OFF)



APPROVED INSULATION: UL CLASSIFIED POLYISOCYANURATE INSULATION.

NOTES:

1. Attach Insulation with Concrete Fasteners and 3" Steel Insulation Plate. Refer to Detail Drawings "Fastening Pattern Insulation/Coverboard GD-2 through GD-11". Minimum 1" penetration.