



PHOENIX
PRODUCTS™

GD-CB(RB)-IN(RB)-VB-C

Quick Spec

GLUE DOWN MEMBRANE - COVER BOARD (RB) - INSULATION (RB) - VAPOR BARRIER - CONCRETE DECK (NEW OR TEAR OFF)

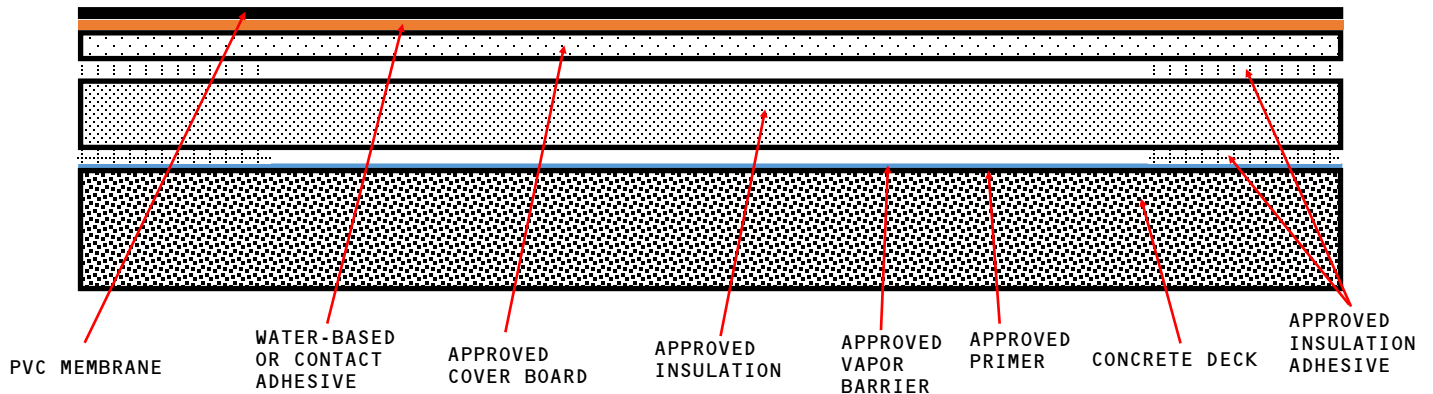

APPROVED COVER BOARD: DENS DECK, DENS DECK PRIME OR SECUROCK GLASS-MAT, MINIMUM 1/4" THICKNESS.

APPROVED INSULATION: UL CLASSIFIED POLYISOCYANURATE, EXPANDED POLYSTYRENE, EXTRUDED POLYSTYRENE INSULATION.

NOTES:

1. Attach Coverboard and Insulation with Approved Insulation Adhesive. Refer to Detail Drawings "Ribbon Insulation Adhesive pattern GD-17 and GD-18".
2. Class A Fire Rating with unlimited slope when utilizing Approved Coverboards.