

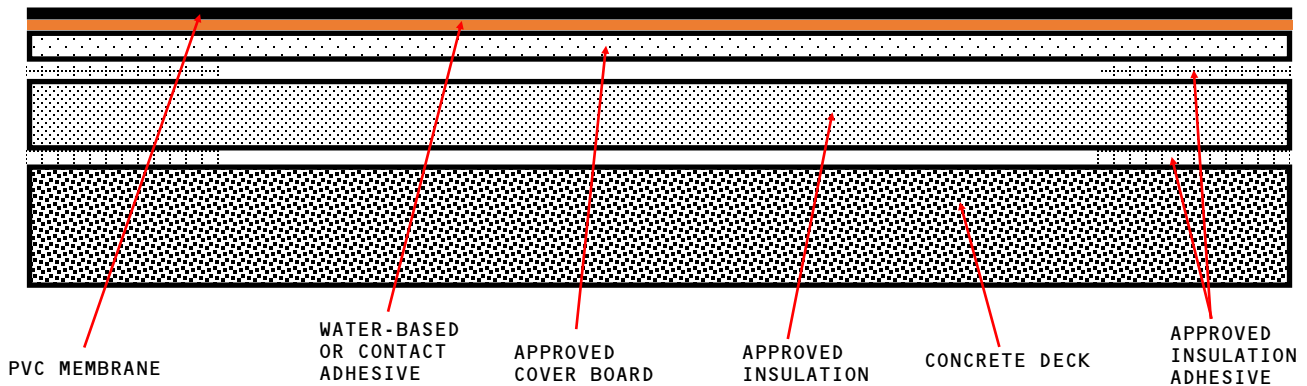

**PHOENIX**  
PRODUCTS™

## GD-CB(RB)-IN(RB)-C Quick Spec

GLUE DOWN MEMBRANE - COVER BOARD (RB) - INSULATION (RB) - CONCRETE DECK (NEW OR TEAR OFF)



**APPROVED COVER BOARD:** DENS DECK, DENS DECK PRIME OR SECUROCK GLASS-MAT, MINIMUM 1/4" THICKNESS.

**APPROVED INSULATION:** UL CLASSIFIED POLYISOCYANURATE, EXPANDED POLYSTYRENE, EXTRUDED POLYSTYRENE INSULATION.

### NOTES:

1. Attach Coverboard and Insulation with Approved Insulation Adhesive. Refer to Detail Drawings "Ribbon Insulation Adhesive pattern GD-17 and GD-18".
2. Class A Fire Rating with unlimited slope when utilizing Approved Coverboards.